

REV	DATE	DESCRIPTION
00	16OCT2020	INITIAL REVISION

- NOTES:
- (⊥) ALL VERTICAL SUPPORTS ARE PERPENDICULAR.
 - FLATNESS OF .5MM IS APPLIED BY DEFAULT.
 - ⊞ WELD BEAD OF 2MM RADIUS IS FOLLOWED.
 - ▽ SURFACE FINISH MEDIUM TO SMOOTH IS USED.
 - ALL TUBES ARE AS PER APL APOLLO STANDARD. CHANGES MAY EFFECT THE LOAD CAPACITY.
 - ALL HORIZONTAL AND VERTICAL TUBES ARE PERPENDICULAR TO EACH OTHER WITH ±1 DEG.
 - FINE WELDING IS REQUIRED AS PER MENTIONED DETAILS AND FINISHING.
 - HIGHER CURRENT WELDING MAY AFFECT THE BRITTLENESS OF MATERIAL WHICH LATER MAY RAISE TO WEAKENING OF STRUCTURE.
 - FABRICATORS ARE ALLOWED TO USE FITTINGS/FRAMES/SUPPORTS AS NEEDED AND THE SAME MUST BE COMMUNICATED BACK TO ENGINEERING TEAM.
 - BOP COMPONENT WEIGHTS ARE FOR REFERENCE ONLY AND SUBJECTED TO CHANGE PER PURCHASED COMPONENTS.

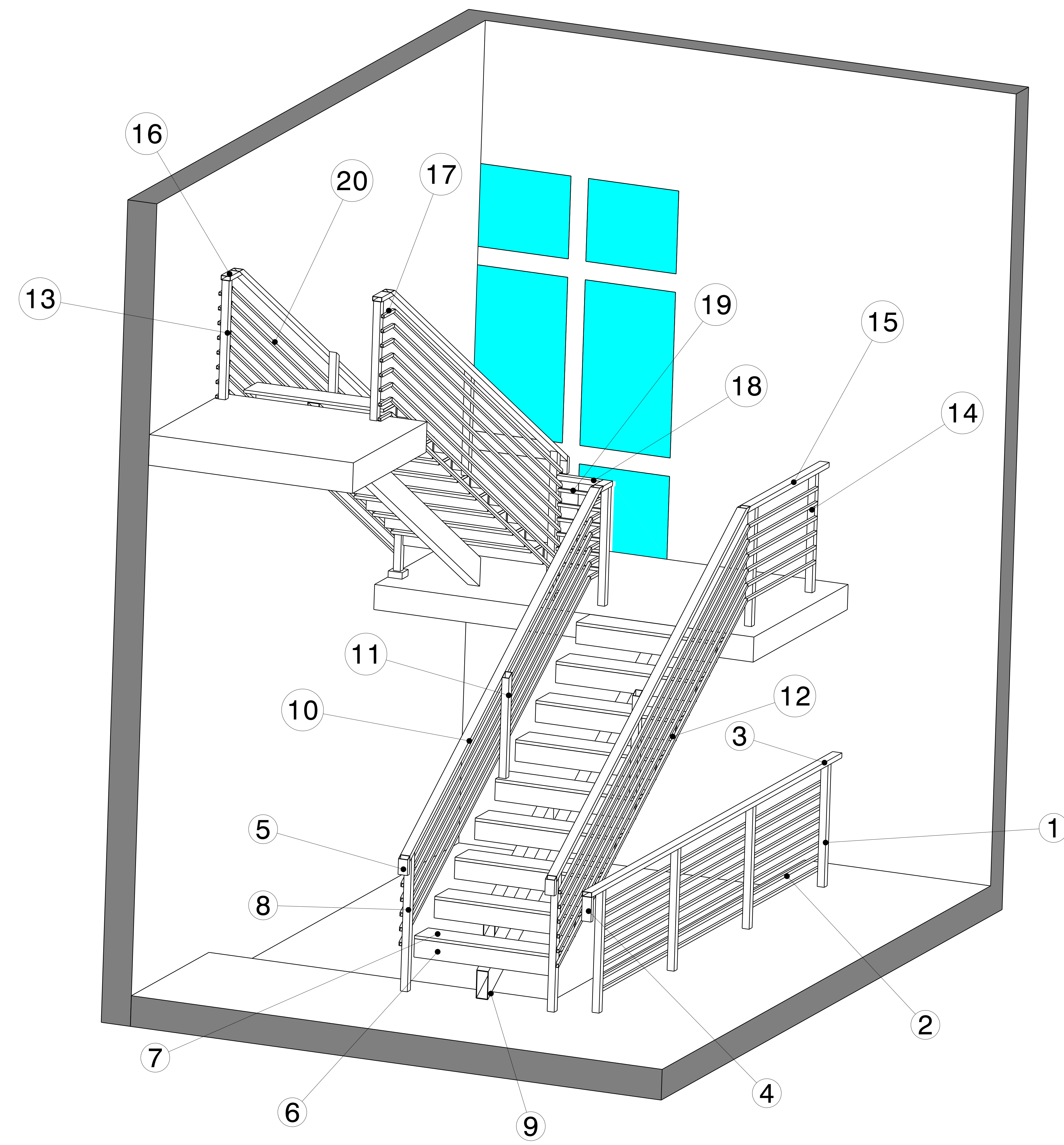

ISOMETRIC VIEW
SCALE : 1:15

ITEM NO.	PART NUMBER	DESCRIPTION	QTY.	Wt(Kg)/Each
20	SHS FRAME 10	25 X 25 X 1.6 X 4110.9	16	4.83
19	SHS FRAME 9	25 X 25 X 1.6 X 385	6	0.45
18	RHS FRAME 8	80 X 40 X 2.6 X 375	1	1.45
17	SHS FRAME 8	25 X 25 X 1.6 X 220.2	16	0.26
16	RHS FRAME 7	80 X 40 X 2.6 X 247.8	3	1.01
15	RHS FRAME 6	80 X 40 X 2.6 X 1641	1	7.54
14	SHS FRAME 7	25 X 25 X 1.6 X 1370.2	6	1.61
13	SHS FRAME 6	60 X 60 X 2.6 X 968.7	5	4.55
12	SHS FRAME 5	25 X 25 X 1.6 X 4212.9	12	4.95
11	SHS FRAME 4	60 X 60 X 2.6 X 852.5	4	3.92
10	RHS FRAME 5	80 X 40 X 2.6 X 4314	4	20.03
9	RHS FRAME 4	200 X 100 X 4 X 4061.4	2	72.41
8	SHS FRAME 3	60 X 60 X 2.6 X 1147.6	4	5.3
7	RHS PLANK 2	275 X 25 X 2 X 1200	18	11.17
6	RHS PLANK 1	150 X 25 X 2 X 1200	18	6.45
5	RHS FRAME 3	80 X 40 X 2.6 X 150.8	4	0.65
4	RHS FRAME 2	80 X 40 X 2.6 X 200	1	0.94
3	RHS FRAME 1	80 X 40 X 2.6 X 5000	1	23.46
2	SHS FRAME 2	25 X 25 X 1.6 X 4500	8	5.3
1	SHS FRAME 1	60 X 60 X 2.6 X 1000	4	4.69

This drawing is our property. It can't be reproduced or communicated without our written agreement.

APL APOLLO TUBES LTD.

DRAWING TITLE: STAIR CASE

SIZE: A0 DRAWING NUMBER: P2P_STAIR CASE REV: 00

SCALE: As Indicated WEIGHT(kg) 0kg SHEET 1 OF 3

UNLESS OTHERWISE SPECIFIED DIMENSION ARE IN MM VIEWS: THIRD ANGLE PROJECTION

DRAWN BY: VM DATE: 16OCT2020
 CHECKED BY: P2P Analysis & Solutions DATE: 16OCT2020
 DESIGNED BY: P2P Analysis & Solutions DATE: 16OCT2020

REV	DATE	DESCRIPTION
00	16OCT2020	INITIAL REVISION

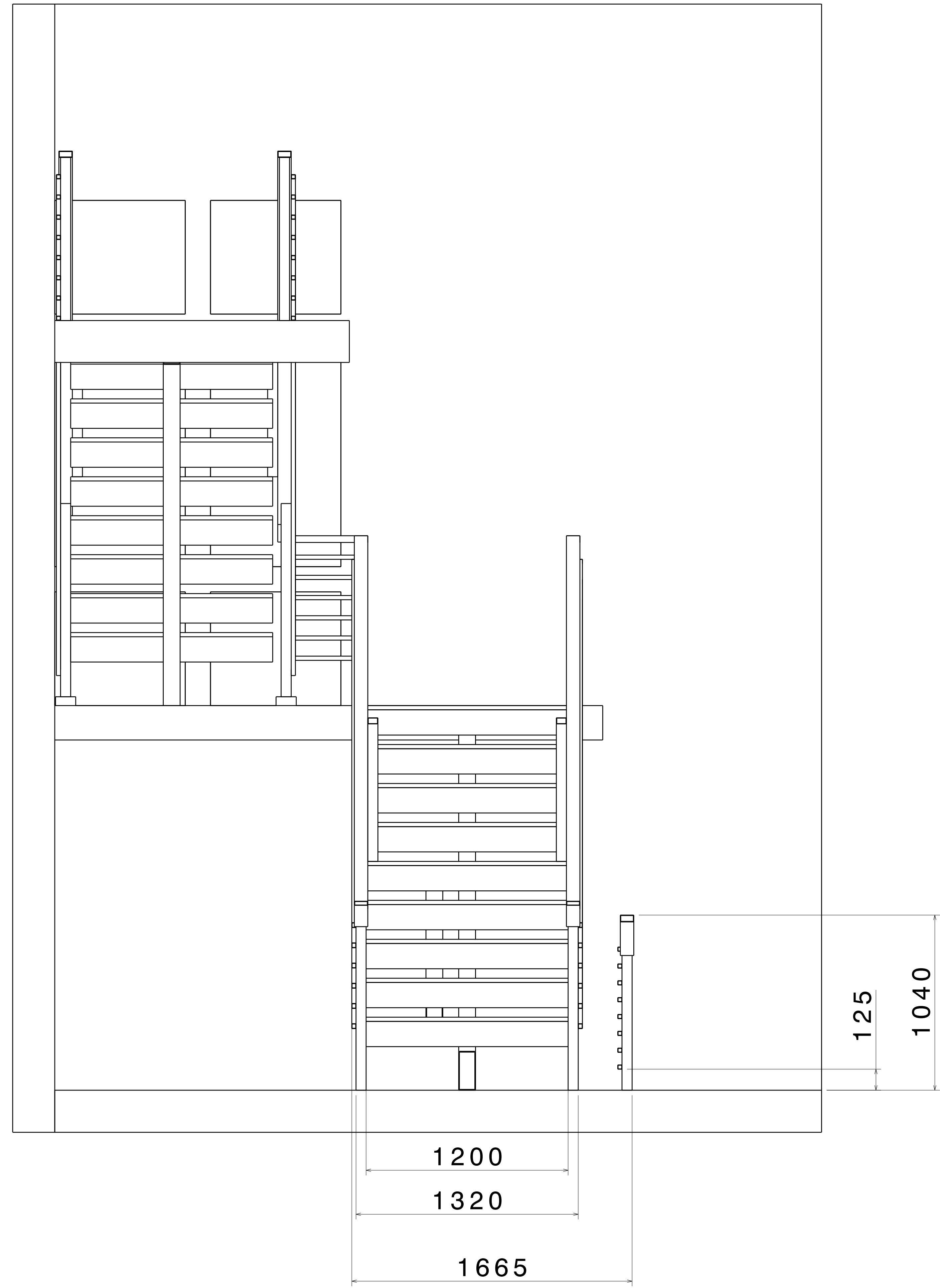

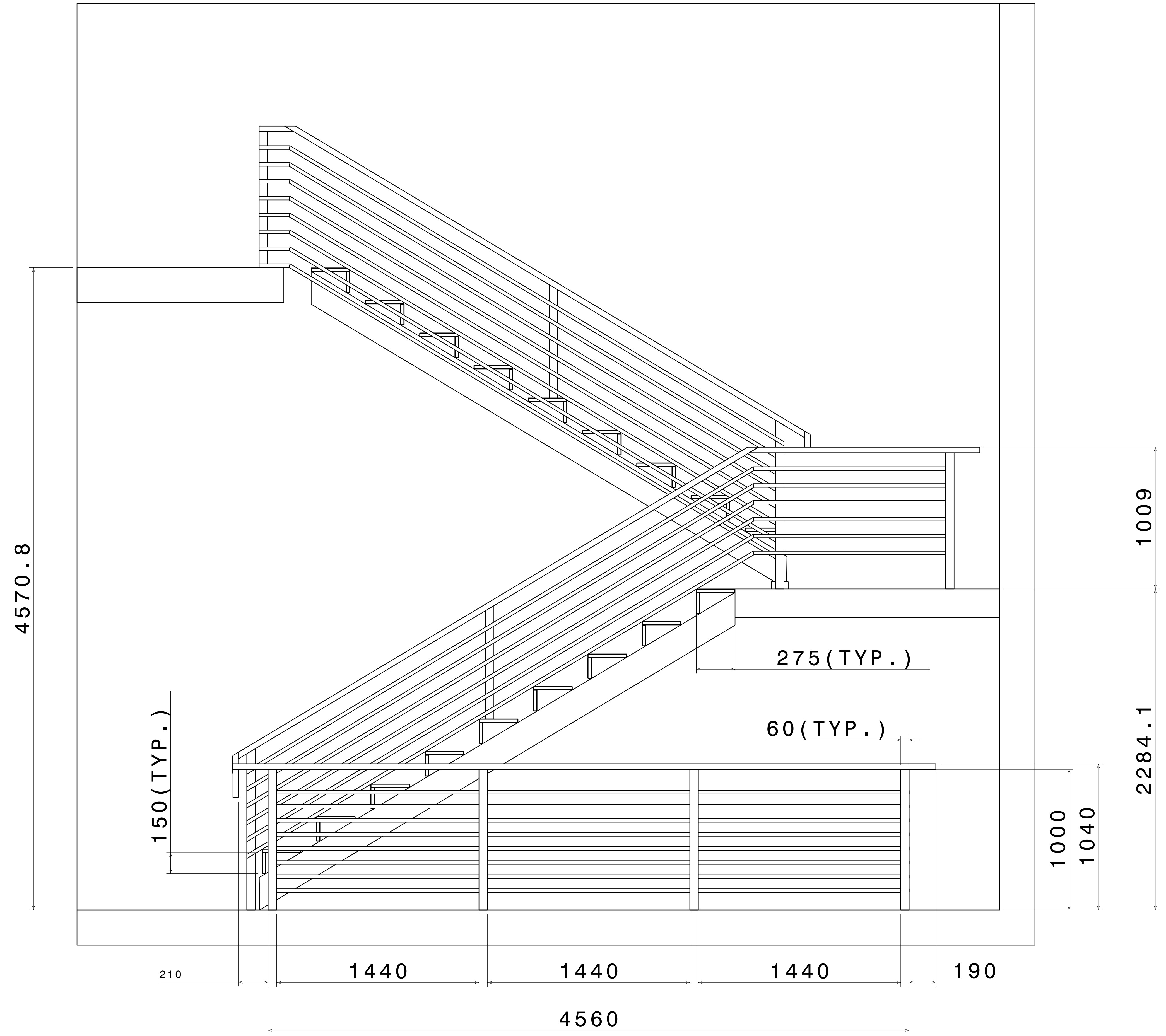

FRONT VIEW
SCALE: 1:15

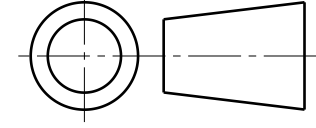

RIGHT VIEW
SCALE: 1:15

UNLESS OTHERWISE SPECIFIED DIMENSION ARE IN MM
VIEWS: THIRD ANGLE PROJECTION



This drawing is our property. It can't be reproduced or communicated without our written agreement.		APL APOLLO TUBES LTD. 	
DRAWN BY SB		DATE 16OCT2020	
CHECKED BY P2P Analysis & Solutions		DATE 16OCT2020	
DESIGNED BY P2P Analysis & Solutions		DATE 16OCT2020	
DRAWING TITLE STAIR CASE		SIZE A0	REV 00
SCALE NONE	WEIGHT (kg) XXX	SHEET 2 OF 3	

REV	DATE	DESCRIPTION
00	16OCT2020	INITIAL REVISION

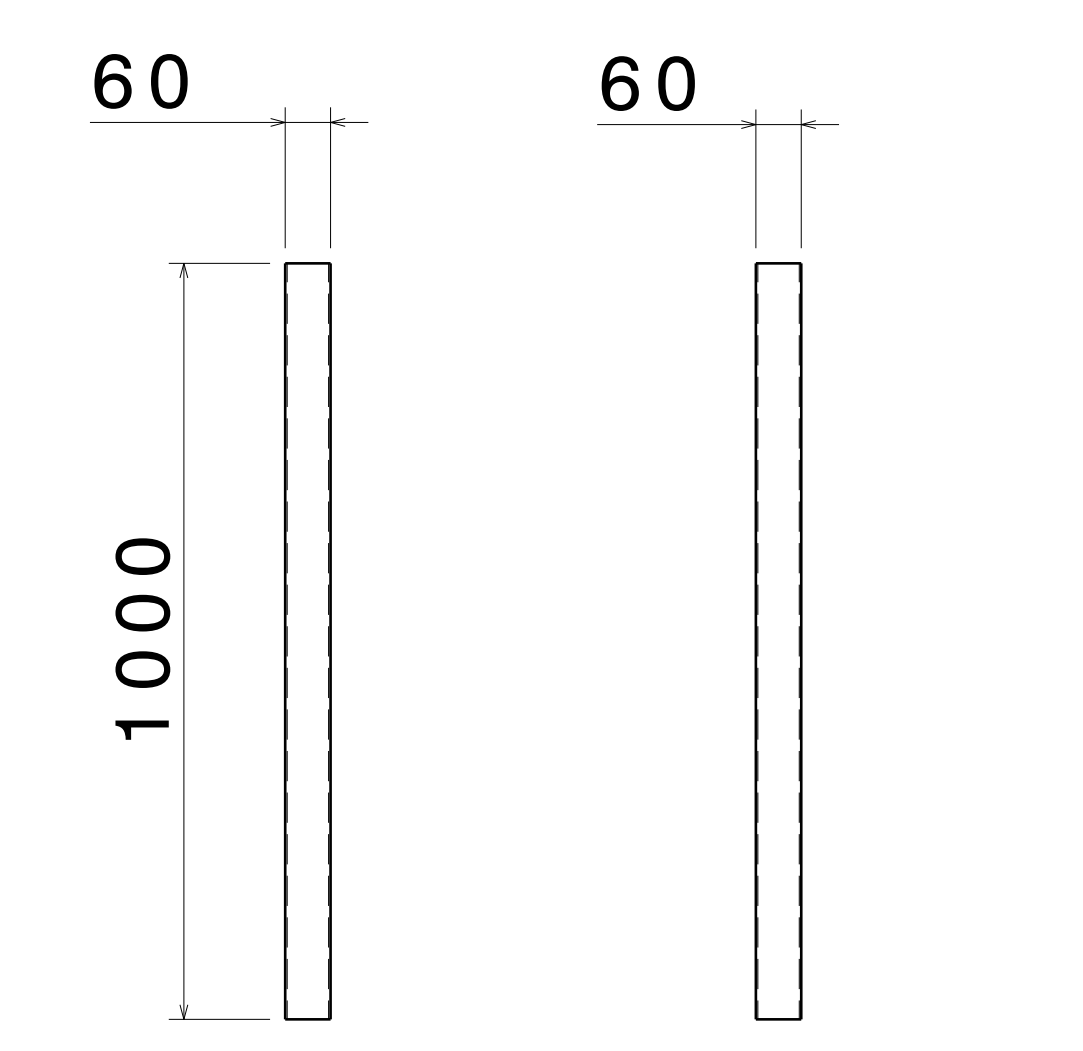

FRONT VIEW RIGHT VIEW
SCALE: 1:10 SCALE: 1:10
ITEM 1, SHS FRAME 1
THICKNESS - 2.6MM

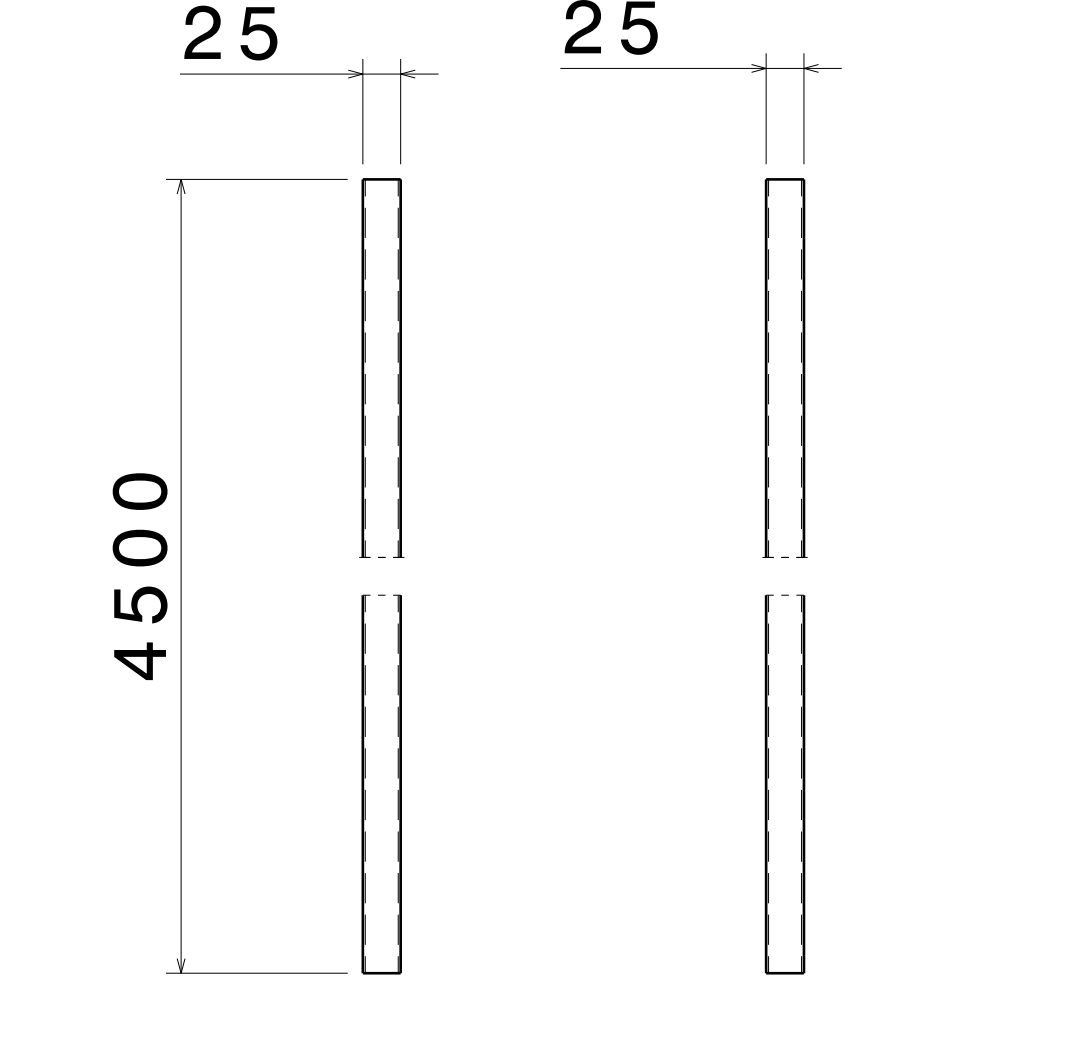

FRONT VIEW RIGHT VIEW
SCALE: 1:5 SCALE: 1:5
ITEM 2, SHS FRAME 2
THICKNESS - 2.6MM

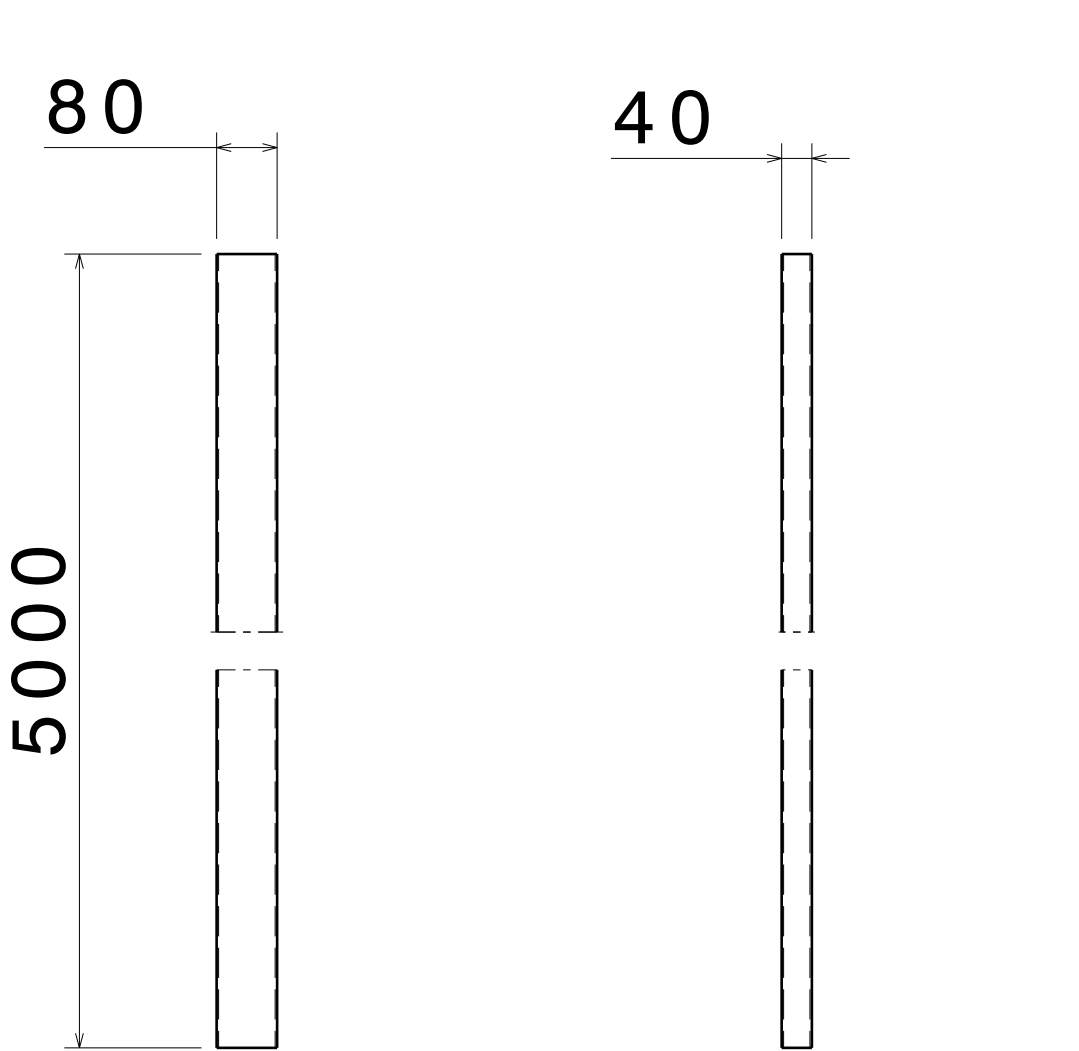

FRONT VIEW RIGHT VIEW
SCALE: 1:10 SCALE: 1:10
ITEM 3, RHS FRAME 1
THICKNESS - 2.6MM

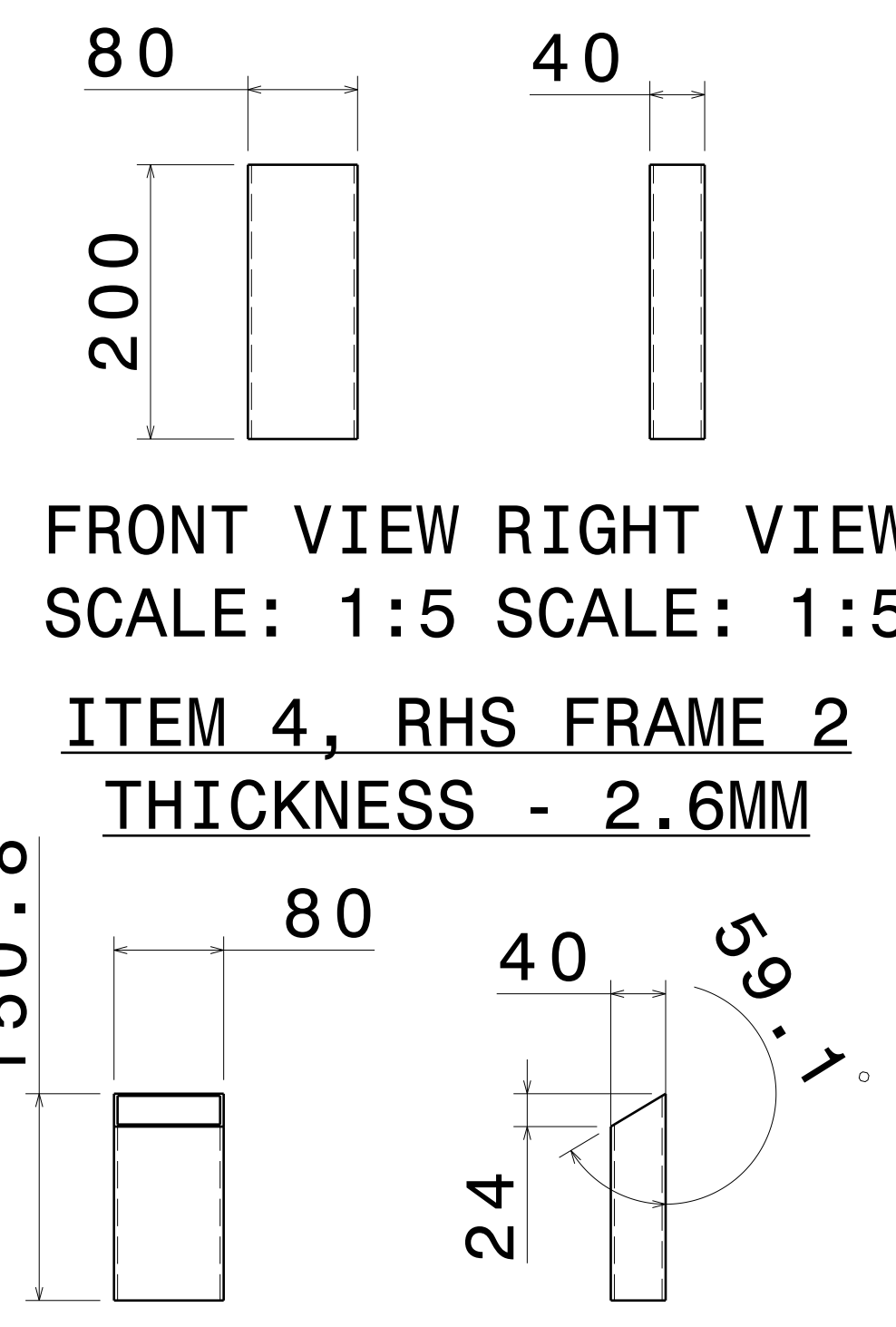

FRONT VIEW RIGHT VIEW
SCALE: 1:5 SCALE: 1:5
ITEM 4, RHS FRAME 2
THICKNESS - 2.6MM

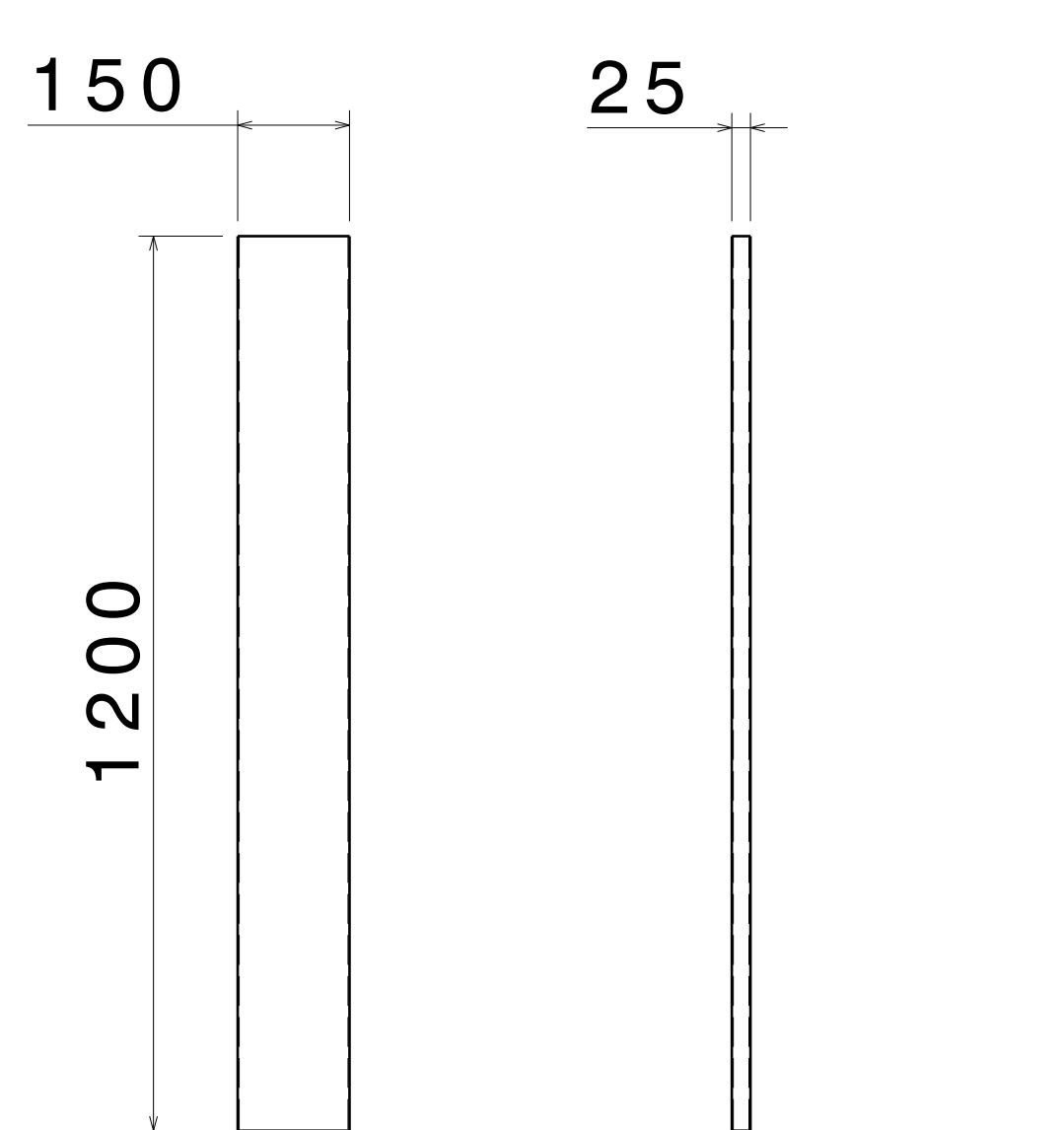

FRONT VIEW RIGHT VIEW
SCALE: 1:10 SCALE: 1:10
ITEM 6, RHS PLANK 1
THICKNESS - 2.0MM

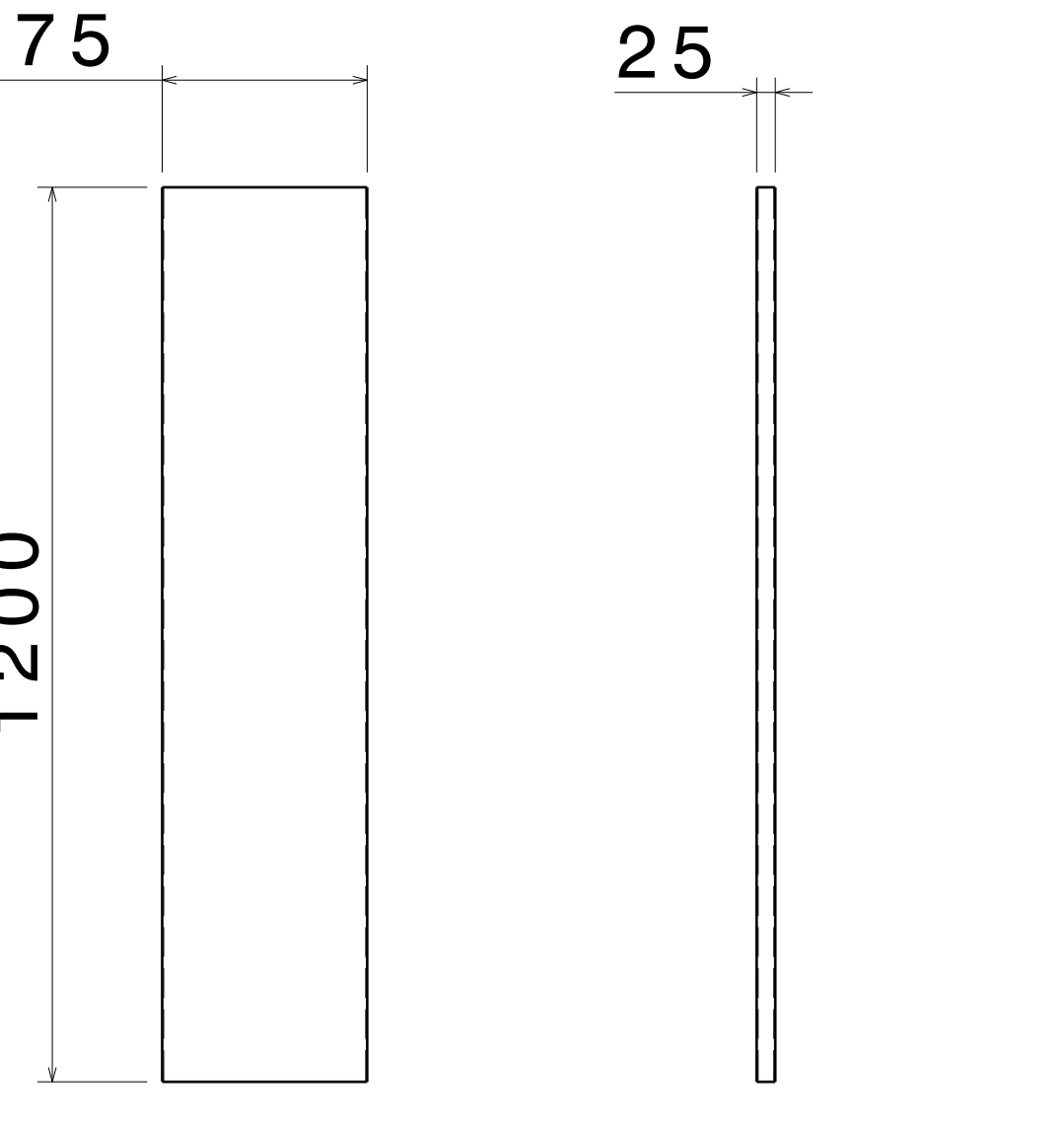

FRONT VIEW RIGHT VIEW
SCALE: 1:10 SCALE: 1:10
ITEM 7, RHS PLANK 2
THICKNESS - 2.0MM

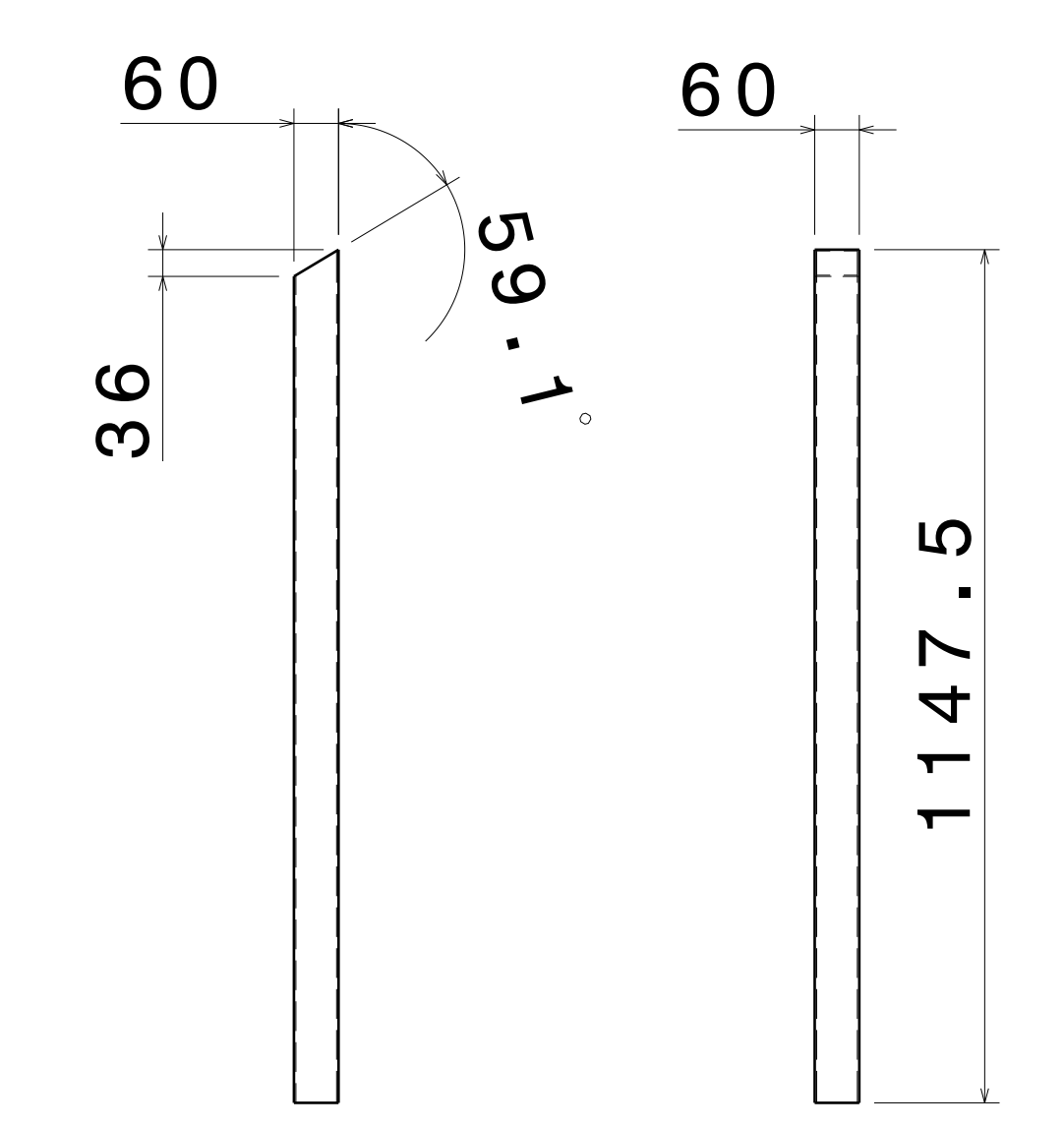

FRONT VIEW RIGHT VIEW
SCALE: 1:10 SCALE: 1:10
ITEM 8, SHS FRAME 3
THICKNESS - 2.6MM

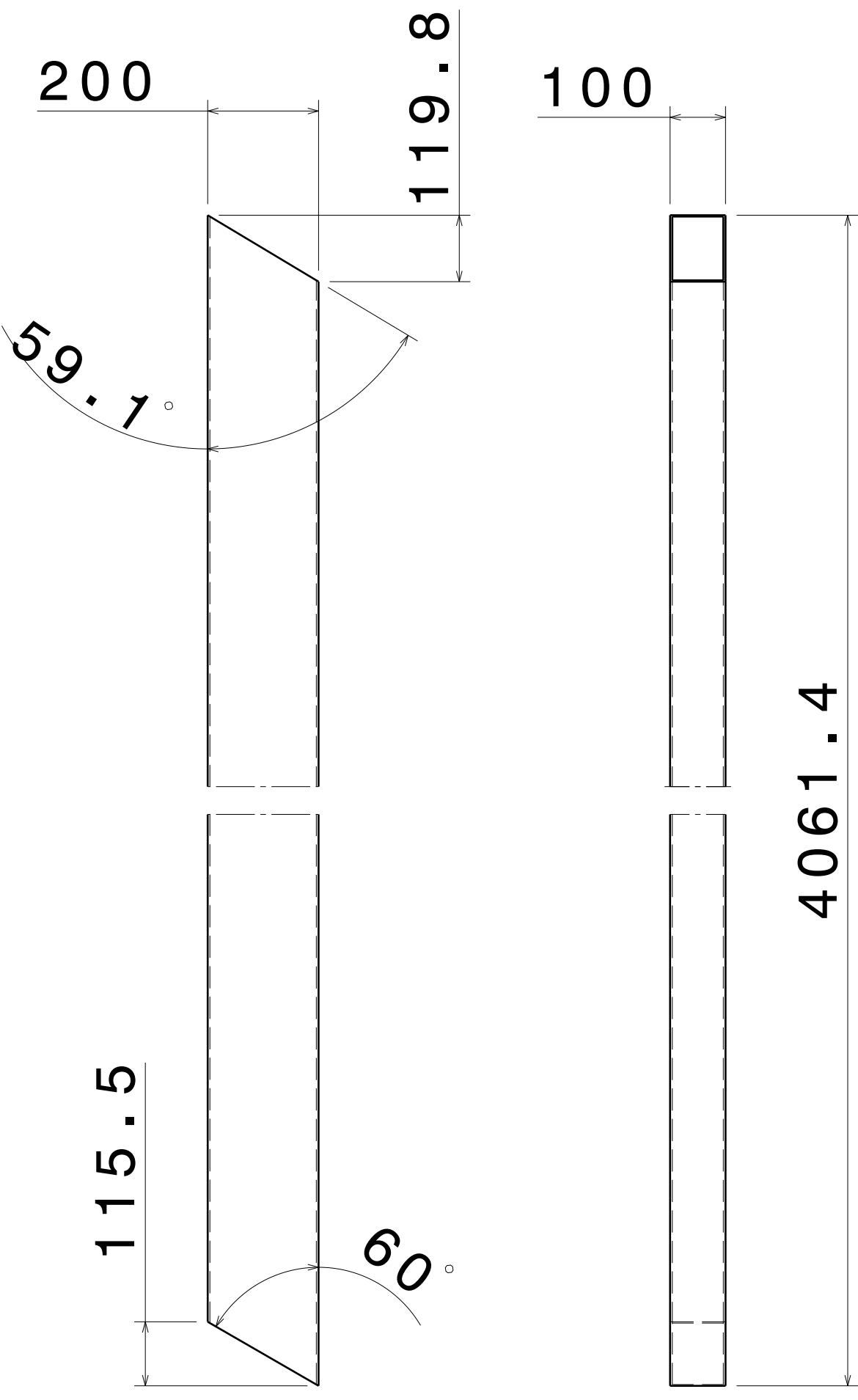

FRONT VIEW RIGHT VIEW
SCALE: 1:10 SCALE: 1:10
ITEM 9, RHS FRAME 4
THICKNESS - 4.0MM

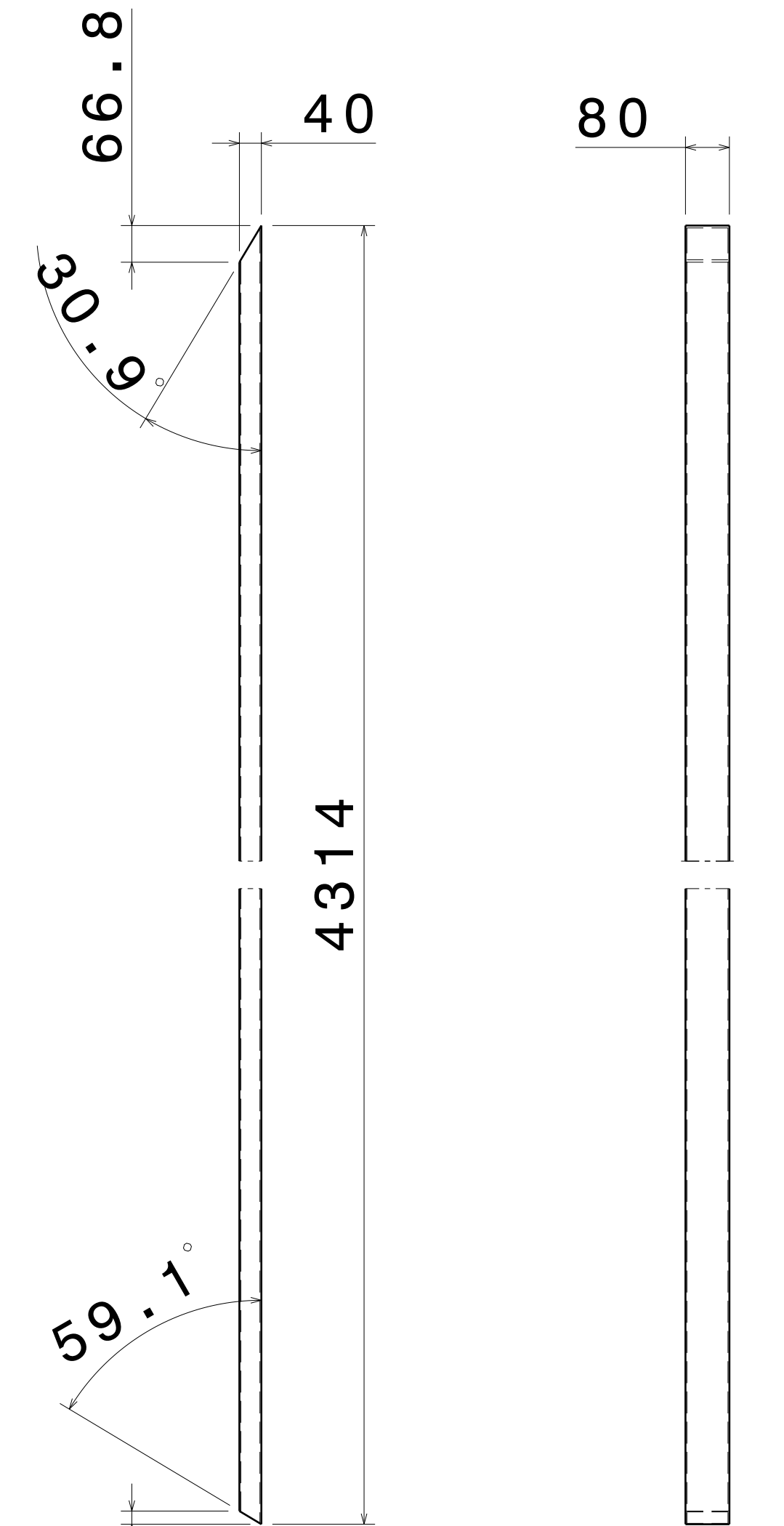

FRONT VIEW RIGHT VIEW
SCALE: 1:10 SCALE: 1:10
ITEM 10, RHS FRAME 5
THICKNESS - 2.6MM

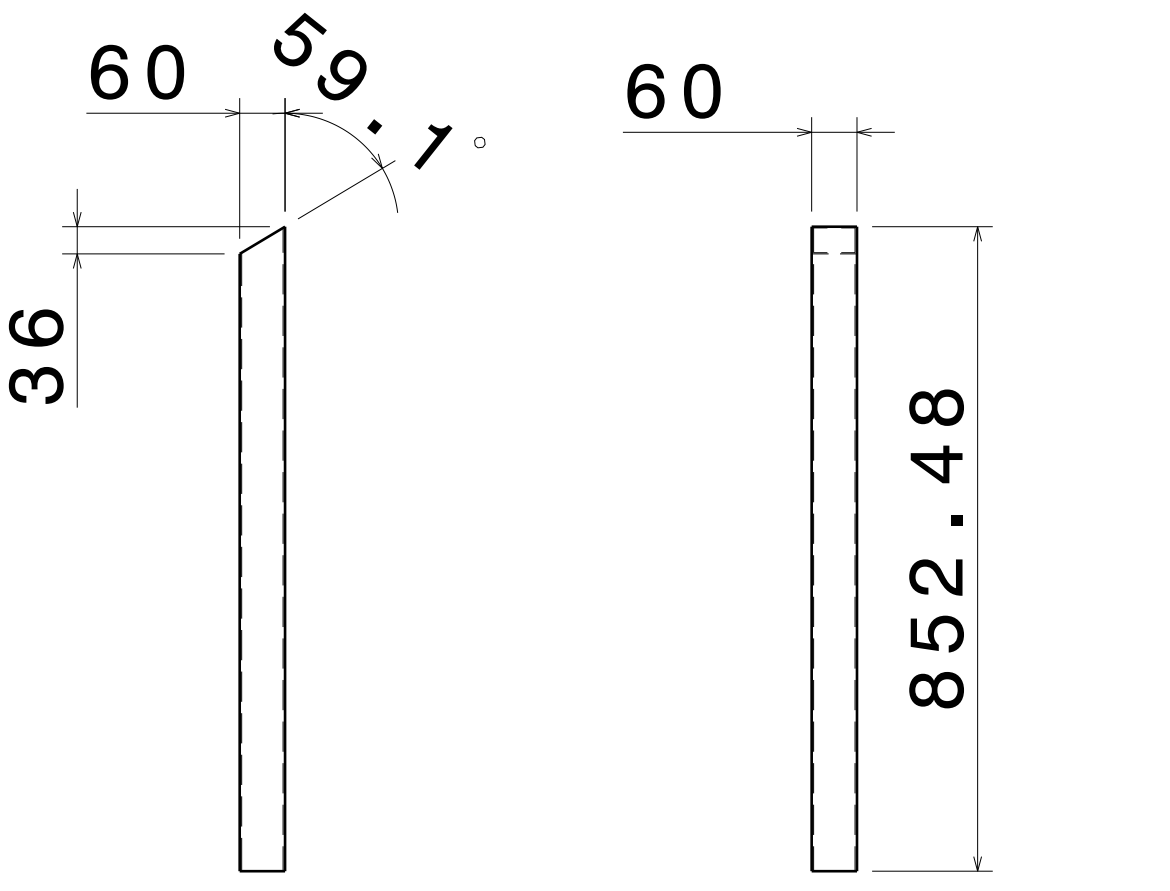

FRONT VIEW RIGHT VIEW
SCALE: 1:10 SCALE: 1:10
ITEM 11, SHS FRAME 4
THICKNESS - 2.6MM

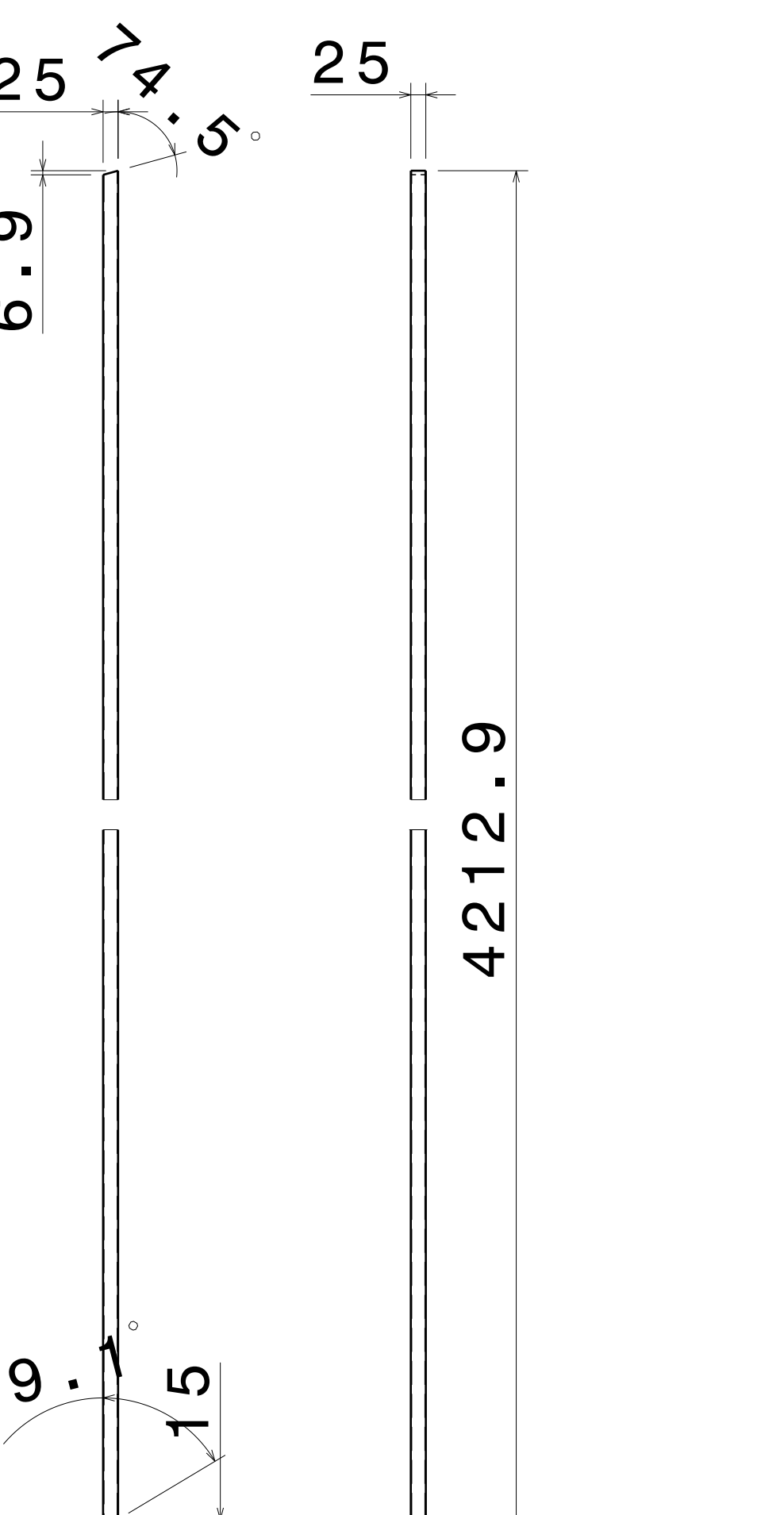

FRONT VIEW RIGHT VIEW
SCALE: 1:10 SCALE: 1:10
ITEM 12, SHS FRAME 5
THICKNESS - 2.6MM

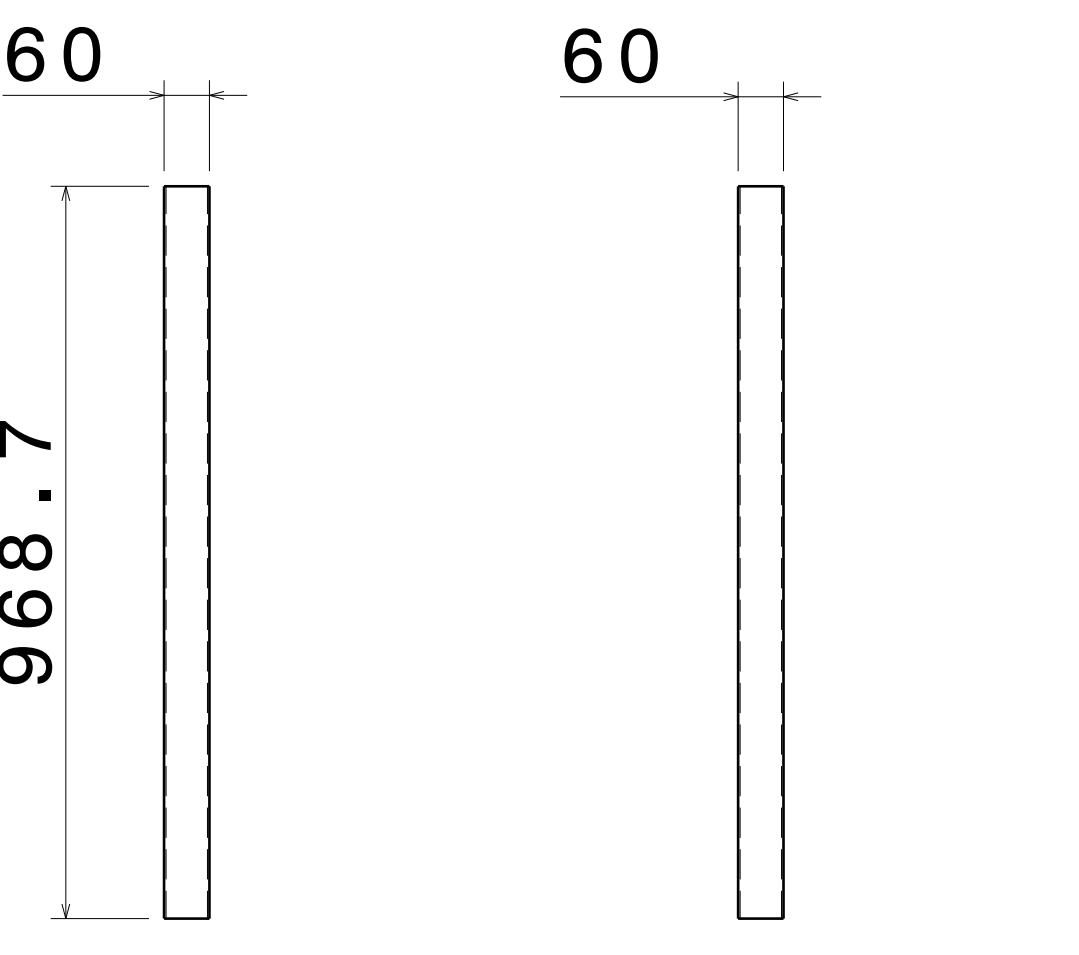

FRONT VIEW RIGHT VIEW
SCALE: 1:10 SCALE: 1:10
ITEM 13, SHS FRAME 6
THICKNESS - 2.6MM

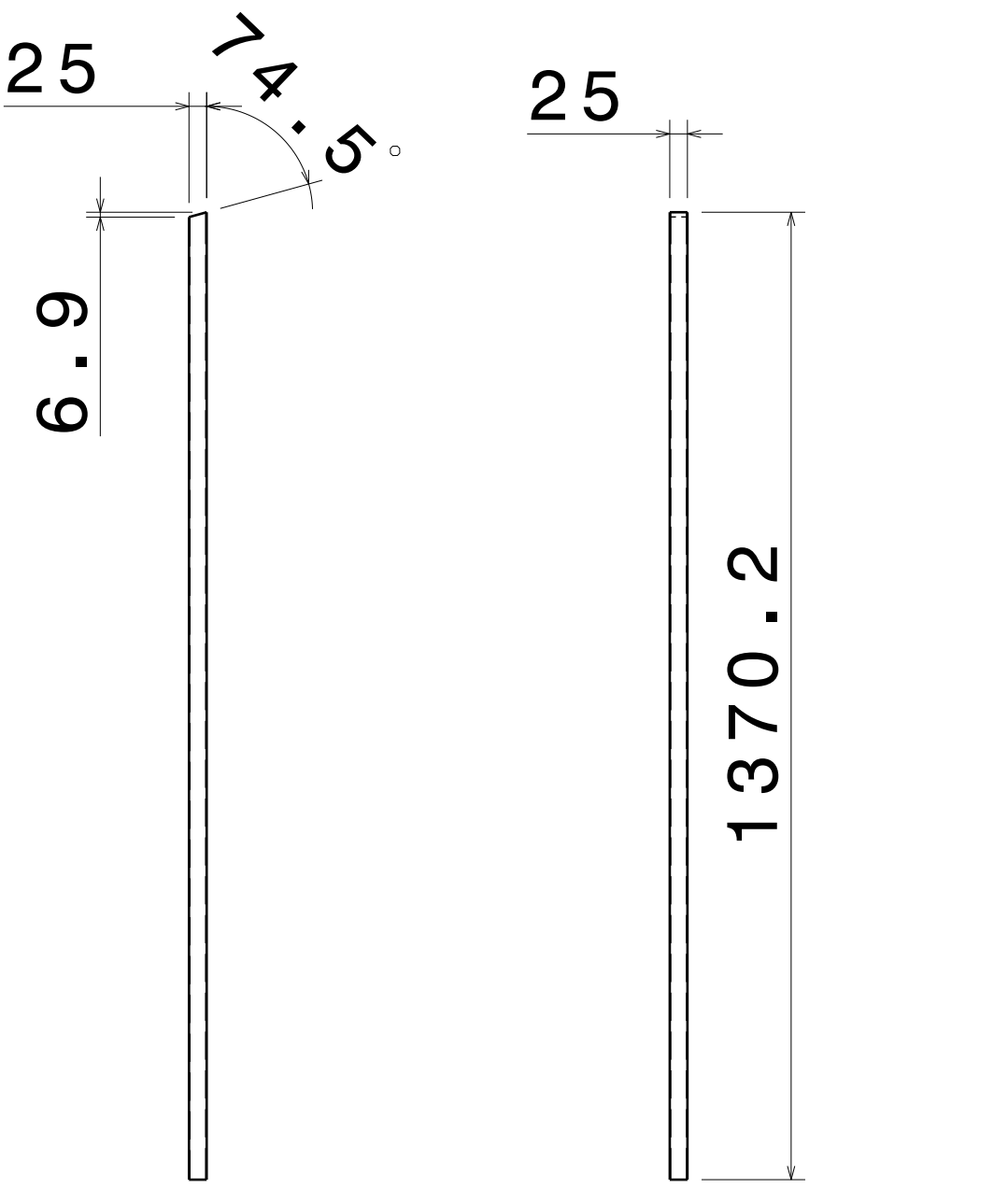

FRONT VIEW RIGHT VIEW
SCALE: 1:10 SCALE: 1:10
ITEM 14, SHS FRAME 7
THICKNESS - 2.6MM

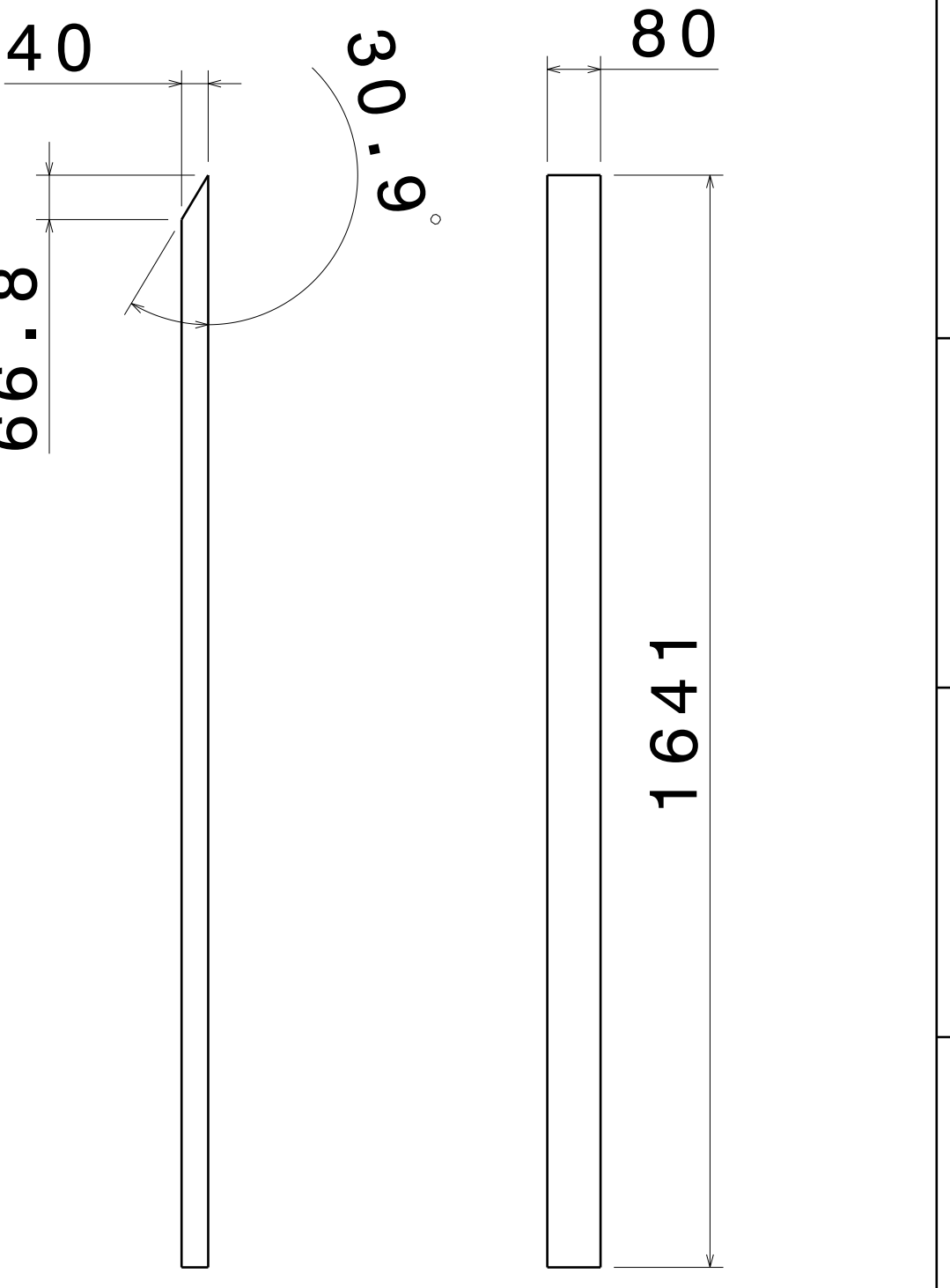

FRONT VIEW RIGHT VIEW
SCALE: 1:10 SCALE: 1:10
ITEM 15, RHS FRAME 6
THICKNESS - 2.6MM

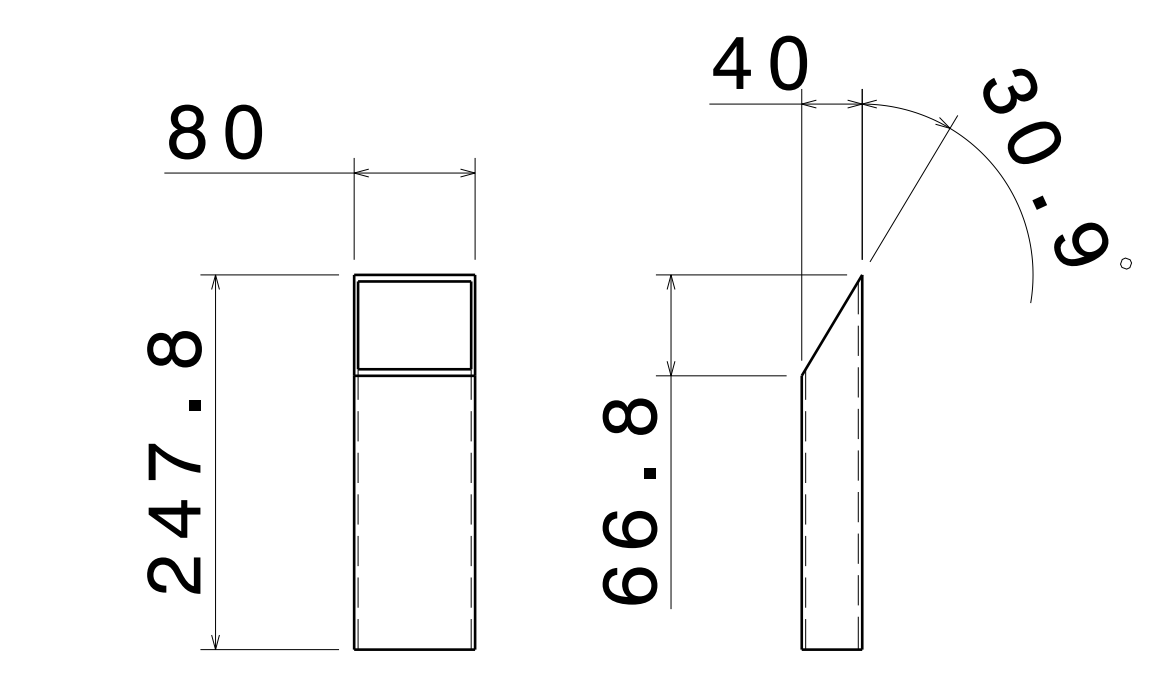

FRONT VIEW RIGHT VIEW
SCALE: 1:5 SCALE: 1:5
ITEM 16, RHS FRAME 7
THICKNESS - 2.6MM

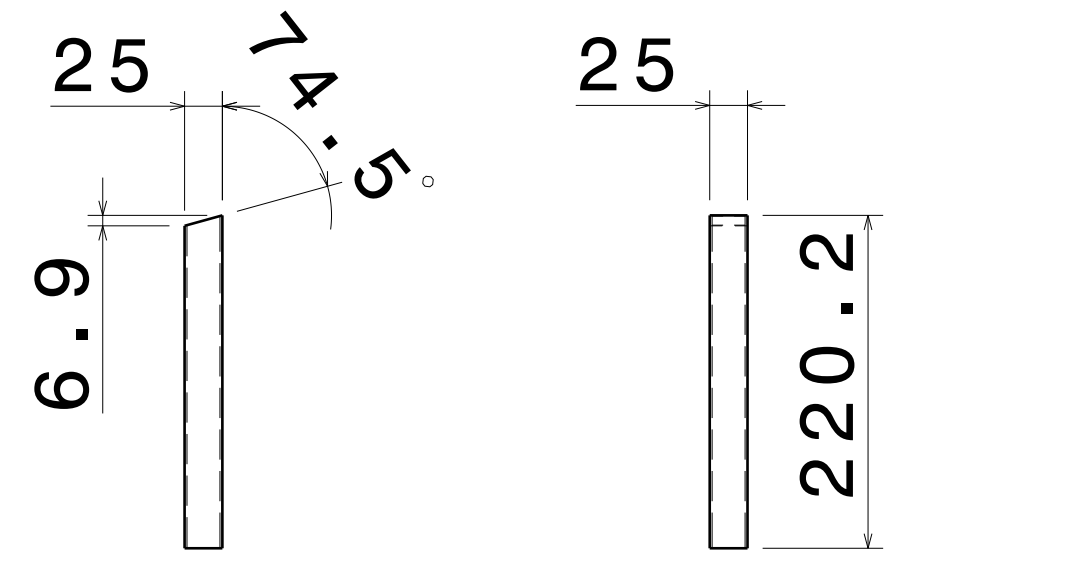

FRONT VIEW RIGHT VIEW
SCALE: 1:5 SCALE: 1:5
ITEM 17, SHS FRAME 8
THICKNESS - 1.6MM

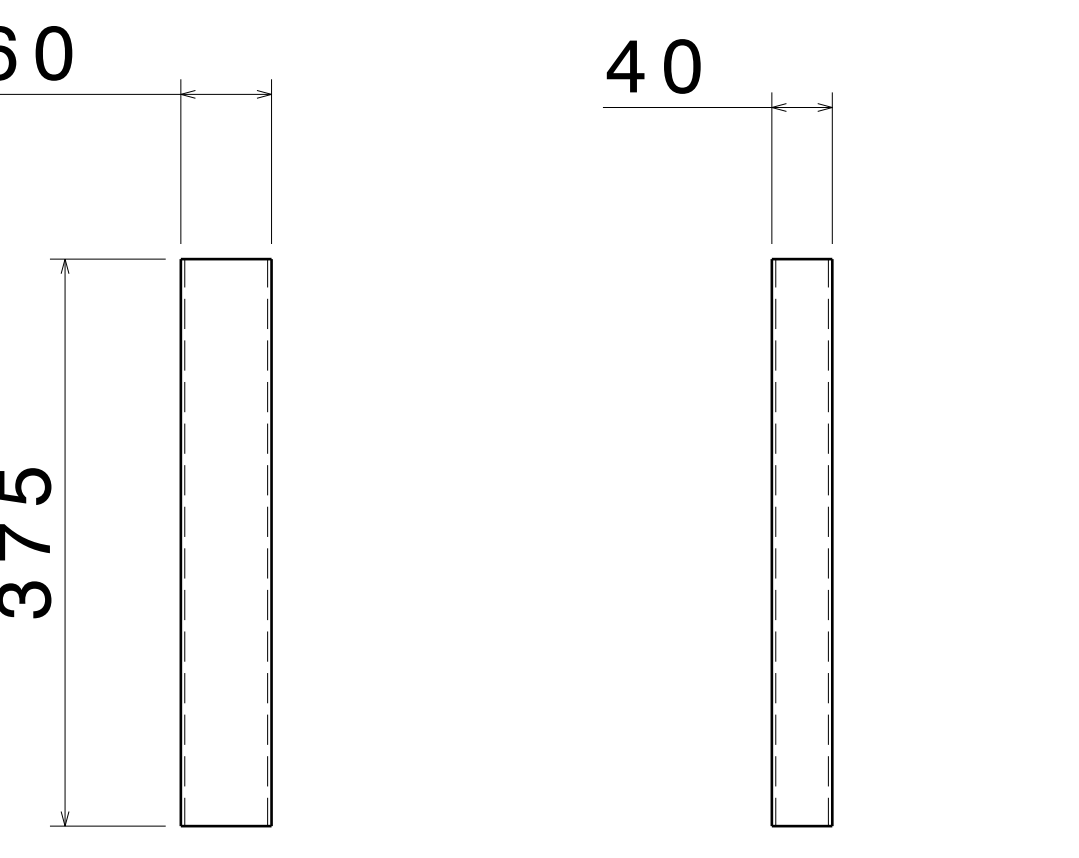

FRONT VIEW RIGHT VIEW
SCALE: 1:5 SCALE: 1:5
ITEM 18, RHS FRAME 8
THICKNESS - 2.6MM

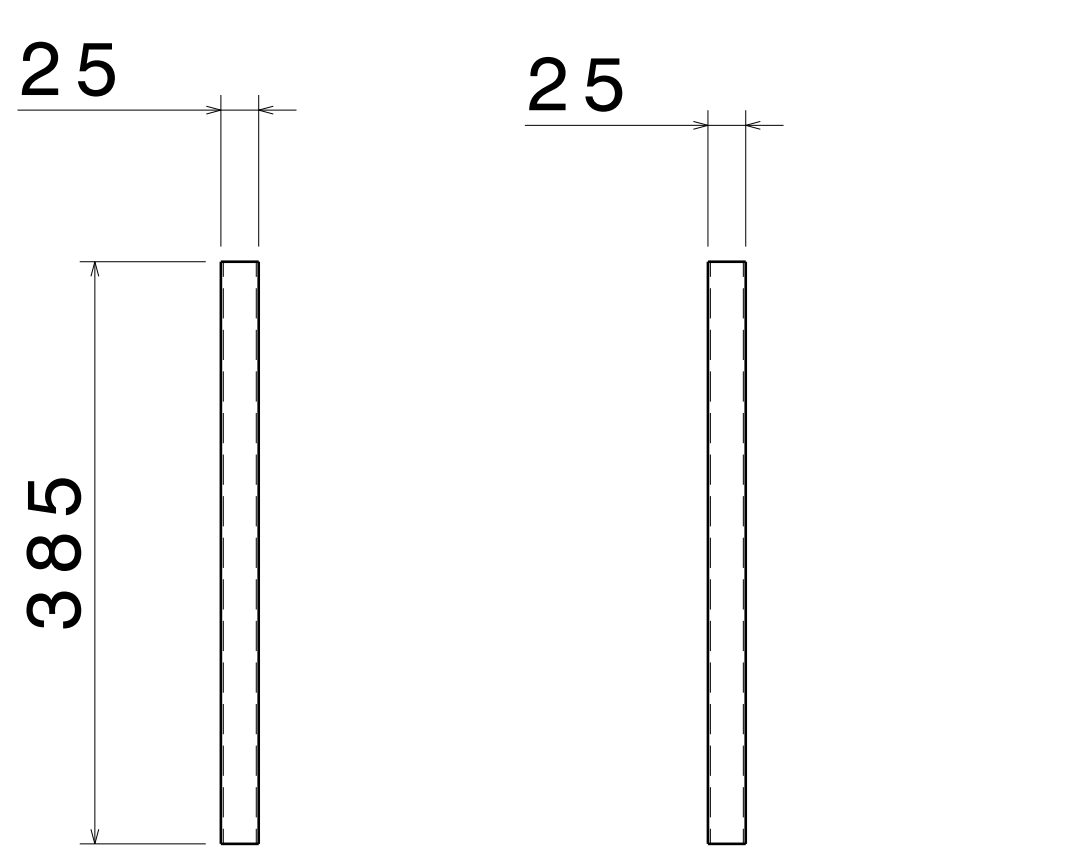

FRONT VIEW RIGHT VIEW
SCALE: 1:5 SCALE: 1:5
ITEM 19, SHS FRAME 9
THICKNESS - 1.6MM

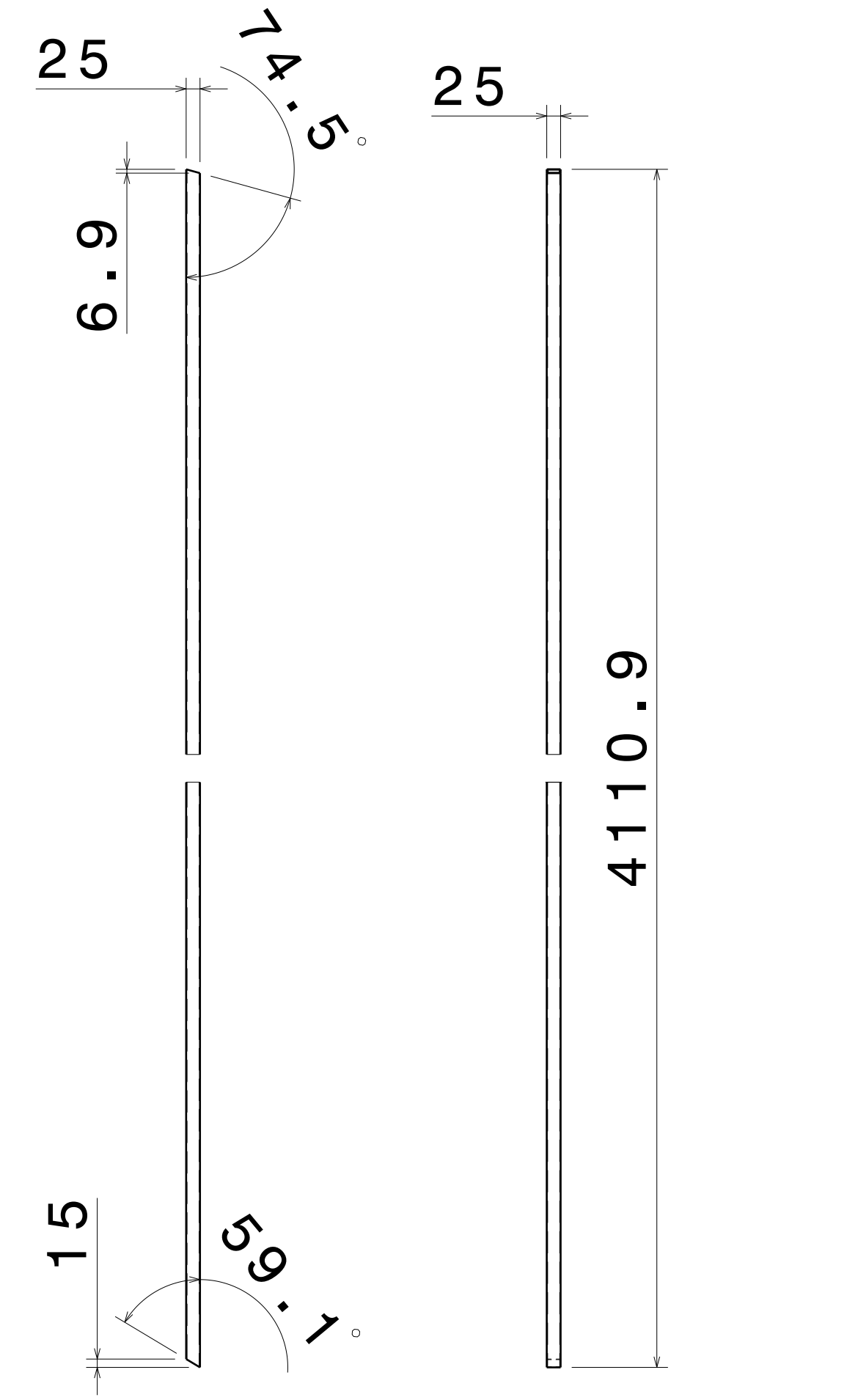

FRONT VIEW RIGHT VIEW
SCALE: 1:5 SCALE: 1:5
ITEM 20, SHS FRAME 10
THICKNESS - 1.6MM

UNLESS OTHERWISE SPECIFIED DIMENSION ARE IN MM VIEWS: THIRD ANGLE PROJECTION

DRAWN BY		DATE	
SB		16OCT2020	
CHECKED BY		DATE	
P2P Analysis & Solutions		16OCT2020	
DESIGNED BY		DATE	
P2P Analysis & Solutions		16OCT2020	

APL APOLLO TUBES LTD.			
DRAWING TITLE			
STAIR CASE			
SIZE	DRAWING NUMBER	REV	
A0	P2P_STAIR CASE	00	
SCALE	NONE	WEIGHT (kg)	XXX
			SHEET 3 OF 3